

- NOTES:
1. COMBINATION LOCK W/SPY-PROOF KEY-LOCKING D & R.
  2. BODY & DOOR, TL-15 PLATE SAFE CONSTRUCTION.
  3. FINISH: TAUPE (S/W #F63VX-A4907-4334)
  4. APPROXIMATE WEIGHT: 1,150 LBS.
  5. MODEL 981-1LS (LEFT SWING AS SHOWN)  
MODEL 981-1RS (RIGHT SWING OPP.)
  6. ONE ADJUSTABLE SHELF PER UNIT.
  7. PREPARED FOR TWO MOVEMENT TIME LOCK.

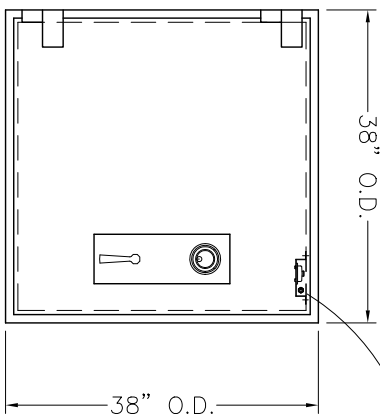

ALARM CONTACT SWITCH

**CAUTION!**  
ONLY PROFESSIONALS EXPERIENCED  
AND QUALIFIED IN THE INSTALLATION  
OF SAFES SHOULD INSTALL THIS  
PRODUCT.

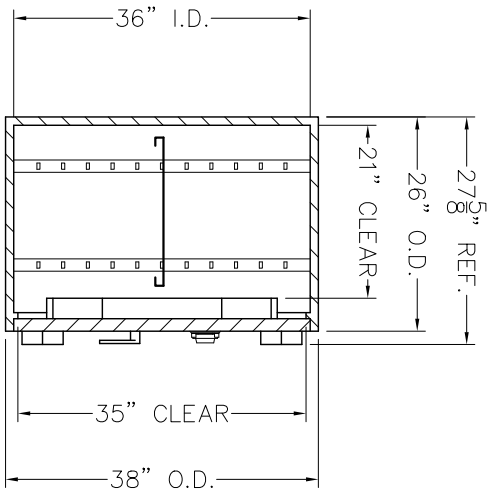
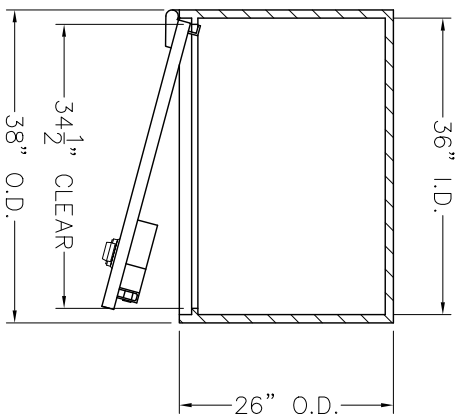

**American**  
**Vault**®  
Waco, Texas

DESCRIPTION  
PRODUCT APPLICATION DRAWING  
981 SERIES PLATE SAFE, TL-15  
MODEL 981-1 (38Hx38Wx26D)

SIZE	DWG. NO.	DATE	SCALE
<b>B</b>	20108	01.09.09	NONE
			SHEET 1 of 2

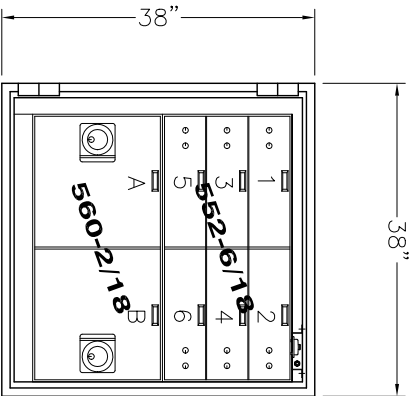

**MODEL 981-1(6/2)**  
 (6) 5x16 TELLER LOCKERS  
 (2) 15x16 CASH LOCKERS

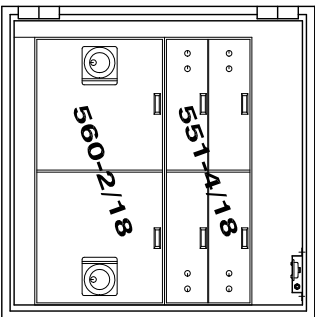

**MODEL 981-1(4/2)**  
 (4) 5x16 TELLER LOCKERS  
 (2) 15x16 CASH LOCKERS

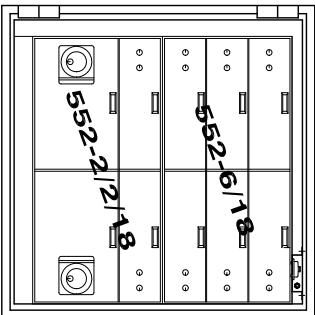

**MODEL 981-1(8/2)**  
 (8) 5x16 TELLER LOCKERS  
 (2) 10x16 CASH LOCKERS

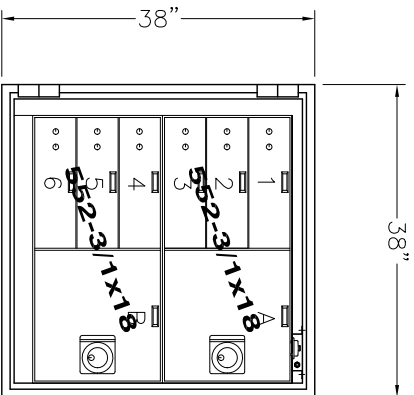

**MODEL 981-1(6/2) A**  
 (6) 5x16 TELLER LOCKERS  
 (2) 15x16 CASH LOCKERS

**CAUTION!**  
 ONLY PROFESSIONALS EXPERIENCED  
 AND QUALIFIED IN THE INSTALLATION  
 OF SAFES SHOULD INSTALL THIS  
 PRODUCT.



**American**  
**Vault**®  
 Waco, Texas

DESCRIPTION  
 PRODUCT APPLICATION DRAWING  
 981 SERIES PLATE SAFE, TL-15  
 MODEL 981-1 (38Hx38Wx26D)

SIZE	DWG. NO.	DATE	SCALE
<b>B</b>	20108	01.09.09	NONE
			SHEET 2 of 2